

ONLEVEL

NEW
CONCEPT



TURBOFLEX
GLASS FIXATION ADJUSTS
TO THE GLASS POSITION

TURBOFLEX PROFILES

A REVOLUTION
IN GLASS ADJUSTMENT

STEP ON THE GAS IN MOUNTING GLASS

NEW
CONCEPT

TURBOFLEX

[Watch installation video](#) ⇒



Key benefits at a glance:

- 1. Completely new concept:** The glass is adjusted exactly where needed – directly at the glass! This ensures instant precision and saves time.
- 2. No subsequent corrections:** Installation takes approximately half the time of conventional systems. A true efficient booster for any construction site.
- 3. Perfect alignment:** TURBOFLEX allows for precise horizontal adjustment as well as secure vertical stability – for an absolutely stable result.
- 4. Optimal tolerance compensation:** Whether minor deviations or major differences – TURBOFLEX perfectly compensates for all glass production tolerances.
- 5. Safe installation:** The entire installation is done from the user side, ensuring maximum safety and eliminating scaffold or powered access costs.
- 6. Precise fit:** The glass pivot point in TURBOFLEX lies directly beneath the rubber gaskets, ensuring a seamless fit – even with varying glass angles.
- 7. Maximum safety:** TURBOFLEX uses stainless steel components for glass fixation, ensuring extremely high tested safety and stability.
- 8. Full-surface glass clamping:** The contact surfaces follow the glass angle, avoiding stress concentrations and ensuring functionality even under high loads.
- 9. Optional:** The height adjuster allows vertical glass adjustment of up to 3 mm

HOW DOES IT WORK?

- 1 ADJUST THE GLASS BY HAND**
- 2 FIX THE GLASS WEDGE**
- 3 DONE.**

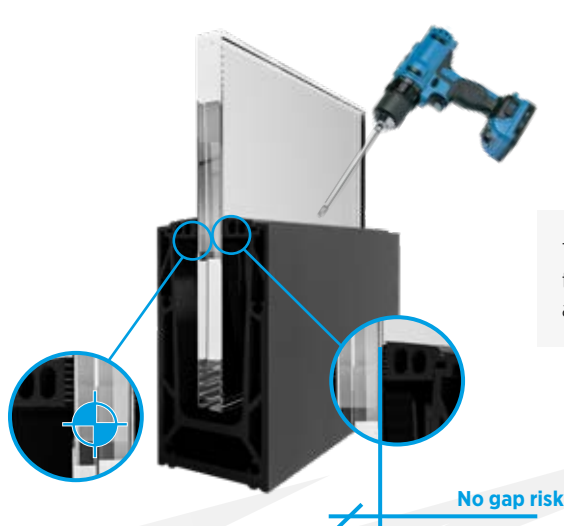

The glass fixing adapts to the position of the glass and is tightened.



= Rotation point of the glass

d = Distance between axis glass rotation and gasket

TURBOFLEX | ACCESSORIES

Glass mounting set



- | Fine adjustment of glass panes
- | For glass thicknesses between 15 - 21.52 mm
- | Length: 5000 mm
- | Pay attention to the right glass thickness!

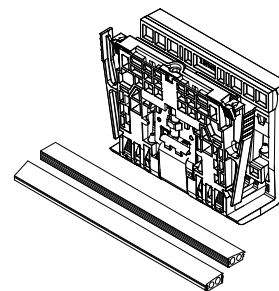

Model 3505	
Glass thickness	Art. No.
15 mm	90.3505.115.00
8/8/2 (16,76 mm)	90.3505.117.00
8/8/4 (17,52 mm)	90.3505.118.00
19 mm	90.3505.119.00
10/10/2 (20,76 mm)	90.3505.121.00
10/10/4 (21,52 mm)	90.3505.122.00

Turbo Torque Tool 6Nm



- | 6Nm
- | Sales unit: 1 piece

Adaptor for tightening TURBOFLEX to 6Nm
Use in conjunction with mounting tool.

Model 0100	
Tool	Art. No.
	90.0100.285.00

TURBOFLEX mounting tool



Easy to handle and an indispensable helper during assembly.

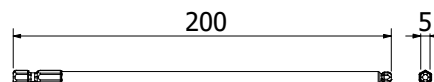

Model 0100	
Tool	Art. No.
	90.0100.280.00

TURBOFLEX glass clamping tool



Optional tool for clamping and aligning two glass panels with each other.

Model 0100	
Tool	Art. No.
	90.0100.230.41

TURBOFLEX | ACCESSORIES

Demobox

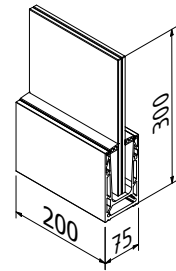

Model 6620

Demobox	Art. No.
	81.6620.001.11

Height adjuster



- | Height adjustment of ± 3 mm
- | Sales unit: 2 pieces

Add the optional height adjuster components to each glass panel to allow precise vertical adjustment.

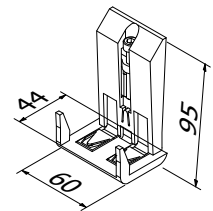

Model 3500

Height adjuster	Art. No.
	90.3500.100.00

TURBOFLEX

Optional for TURBOFLEX: Height adjustment

- The optional height adjustment allows for precise vertical adjustment
- The adjustment range is ± 3 mm per side

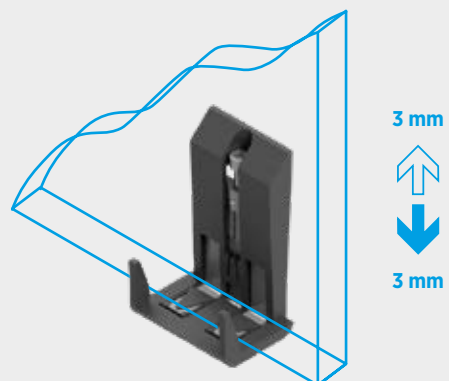

SYSTEM ACCESSORIES

Optional: Mounting console

This steel mounting console (zinc plated) is designed for securely installing glass railing profiles at a distance from the mounting surface. It ensures structural stability while allowing for precise alignment and clean aesthetics, especially in scenarios where direct fixing is not possible.

Product highlights:

- Strong construction: Engineered to handle high loads with minimal deflection
- Fast installation: Pre-drilled for standard bolts or anchors

Ideal applications:

- Balcony and terrace balustrades with insulation or cladding
- Façade installations with uneven or recessed mounting surfaces
- Projects requiring visual spacing or drainage clearance

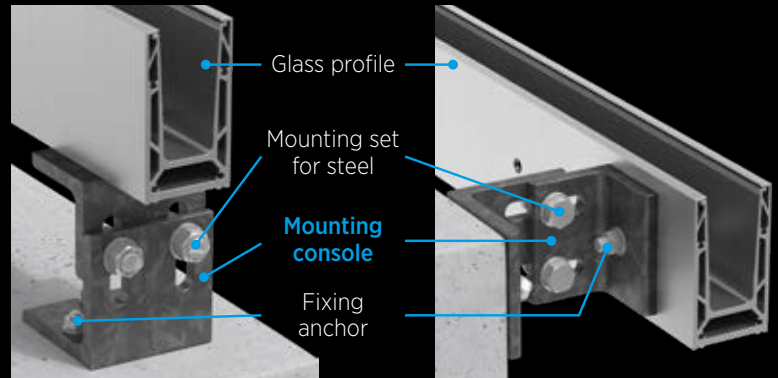

Top mount

Side mount

Mounting console



- | Finish: hit-dip galvanised
- | Material: steel, zinc, galvanised
- | Distance: every 400 mm
- | Distance (height) = 110 - 150 mm
- | Static calculation

Model 9007	Zinc-plated steel (inside)
Art. No.	
90.9007.110.81	

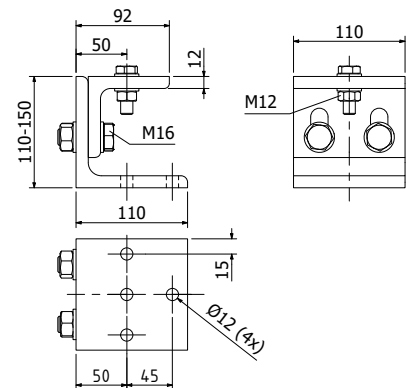

Fischer fixing anchor FAZ II 10/50



- | Finish exterior application: AISI 316
- | Required number per 2500 mm: 14 pieces / 7 mounting consoles
- | M10
- | Sales unit: 20 pieces

Model 3501	AISI 316 (exterior)
Art. No.	
91.3501.050.30	

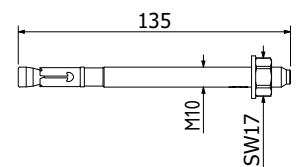

Mounting set for steel



- | Finish exterior application: AISI 316
- | Required number per 2500 mm: 14 pieces / 7 mounting consoles
- | M10 x 45 mm
- | Sales unit: 14 pieces

Model 6620	AISI 316 (exterior)
Art. No.	
91.6620.045.30	

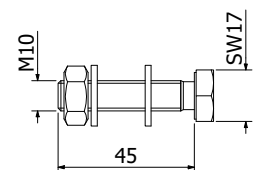



TURBOFLEX GLASS PROFILE TF-3620

1.0 kN Top mount

TURBOFLEX is an innovative glass railing system engineered to accelerate installation while ensuring uncompromised safety, precise alignment, and refined aesthetics. It overturns the conventional method: instead of adjusting the fixation to suit the glass, TURBOFLEX adapts directly to the glass itself – at the point of contact.

TF-3620 has been specifically developed for top mounted installations and can be easily secured to concrete, especially at floor edges, creating additional valuable terrace space. Thanks to its intelligent design, installation is completed quickly and with perfect alignment in just a few steps. The result is not only visually impressive but also reliably meets all technical requirements.

Essential features

- | Slim, elegant design and low maintenance
- | Uses TURBOFLEX mounting technology
- | Extension pin location holes
- | Built-in drainage
- | Can be used with Top Covers
- | For glass thicknesses 15-21.52mm
- | Easy installation with the Turbo Torque Tool
- | Align glass by hand
- | Screw fastening
- | Available in 2,5 and 5 m

Watch Installation Video:



Online manual:
Model TF-3620 without
height adjustment



Online manual:
Model TF-3620 with
height adjustment



TESTED
according to
BS6180

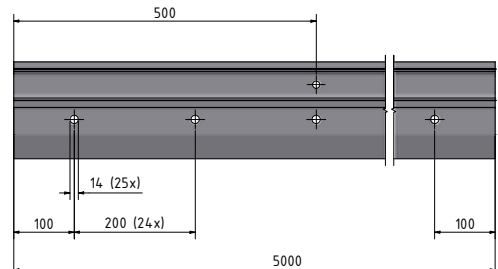
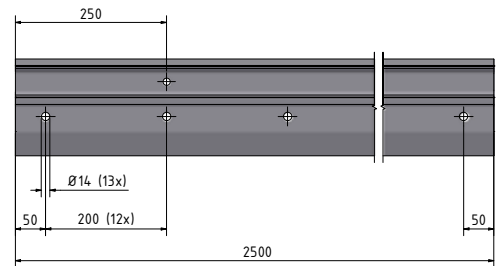
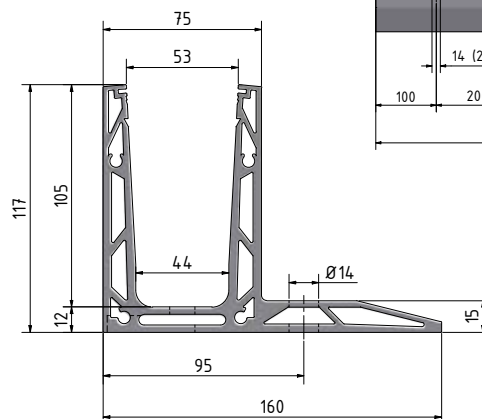
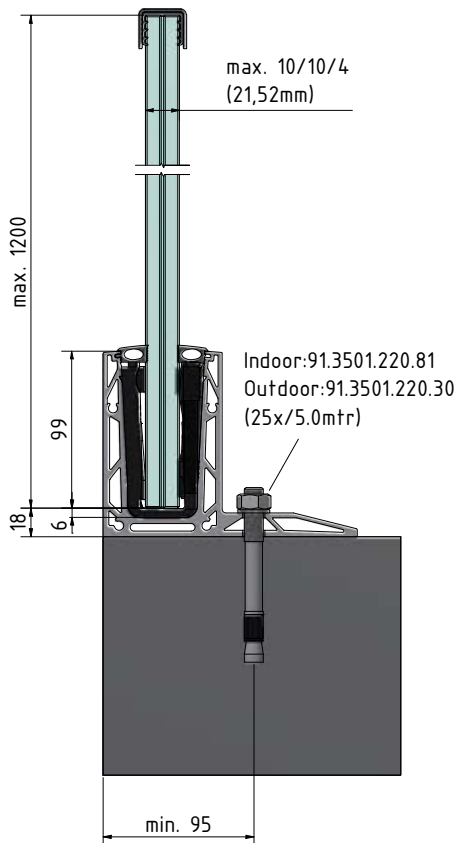



equipped
with



TURBOFLEX
GLASS FIXATION ADJUSTS
TO THE GLASS POSITION



Top mount



TF-3620 | 1.0 KN TOP MOUNT

Glass profile



| Length: 2,5 and 5 m
| Sales unit: 1 piece

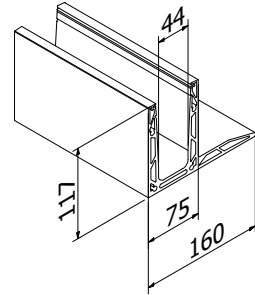

Model 3620	Mill finish	Plain aluminium	RAL coloured
Length	Art. No.	Art. No.	Art. No.
2,5 m	10.3620.002.10	10.3620.002.11	10.3620.002.13/16/18/19
5 m	10.3620.005.10	10.3620.005.11	10.3620.005.13/16/18/19

Inside corner 90°



| Side length inside 40 mm
| Side length outside 200 mm
| Sales unit: 1 piece

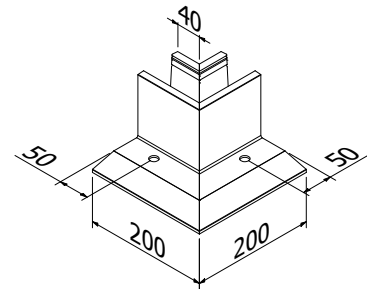

Model 3620	Mill finish	Plain aluminium	RAL coloured
	Art. No.	Art. No.	Art. No.
	10.3620.300.10	10.3620.300.11	10.3620.300.13/16/18/19

Outside corner 90°



| Side length inside 40 mm
| Side length outside 200 mm
| Sales unit: 1 piece

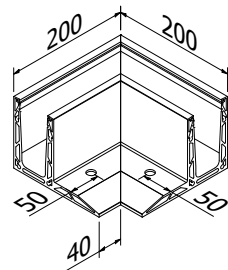

Model 3620	Mill finish	Plain aluminium	RAL coloured
	Art. No.	Art. No.	Art. No.
	10.3620.350.10	10.3620.350.11	10.3620.350.13/16/18/19

TF-3620 | 1.0 KN TOP MOUNT

End cap, left



| For use on the left
| Sales unit: 1 piece

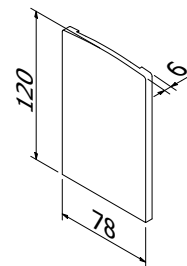

Model 3620	Mill finish	Plain aluminium	RAL coloured
Application	Art. No.	Art. No.	Art. No.
Left	10.3620.400.10	10.3620.400.11	10.3620.400.13/16/18/19

End cap, right



| For use on the right
| Sales unit: 1 piece

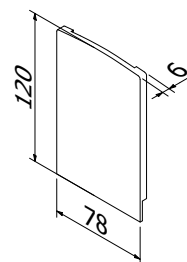

Model 3620	Mill finish	Plain aluminium	RAL coloured
Application	Art. No.	Art. No.	Art. No.
Right	10.3620.450.10	10.3620.450.11	10.3620.450.13/16/18/19

TF-3620 | 1.0 KN TOP MOUNT

Spacer



For additional drainage solutions on your balcony, simply mount the spacers beneath the profile

- | Outlet Ø 14 mm
- | Sales unit: 13 pieces

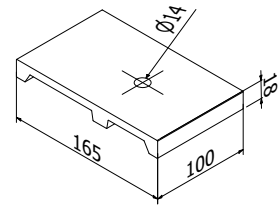

Model 3620	Mill finish	Plain aluminium	RAL coloured
	Art. No.	Art. No.	Art. No.
	10.3620.500.10	10.3620.500.11	10.3620.500.13/16/18/19

Extension pin



- | Length 40 mm
- | Diameter Ø 6 mm
- | Sales unit: 8 pieces

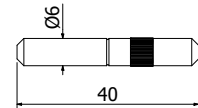

Model 7001	AISI 316 (inside & outside)
	Art. No.
	90.7001.640.31

Fischer fixing anchor FAZ II 12/10



- | Required number per 5000 mm: 25 pieces
- | Sales unit: 20 pieces

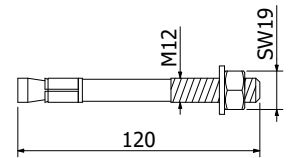

Model 3501	Zinc-plated steel (inside)	AISI 316 (exterior)
	Art. No.	Art. No.
	91.3501.220.81	91.3501.220.30

Mounting set for steel



- | Required number per 5000 mm: 25 pieces
- | M12 x 50 mm
- | Sales unit: 13 pieces

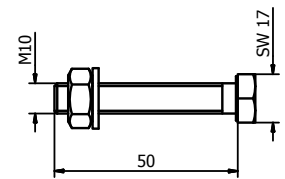

Model 3010	Zinc-plated steel (inside)	AISI 316 (exterior)
	Art. No.	Art. No.
	91.3010.050.81	91.3010.050.30

Mounting set for wood



- | Finish interior application: zinc-plated steel
- | Required number per 2500 mm: 13 pieces
- | RAMPA | M12 x 35 mm
- | Sales unit: 13 pieces

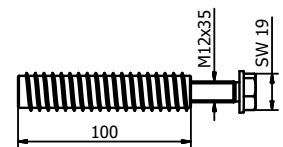

Model 3010	Zinc-plated steel (inside)
	Art. No.
	91.3010.800.81



TURBOFLEX GLASS PROFILE TF-3621

1.0 kN Side mount

TURBOFLEX is an innovative glass railing system engineered to accelerate installation while ensuring uncompromised safety, precise alignment, and refined aesthetics. It overturns the conventional method: instead of adjusting the fixation to suit the glass, TURBOFLEX adapts directly to the glass itself— at the point of contact

TF-3621 has been specifically developed for side-mounted installations and can be easily secured to concrete and steel substrates. Thanks to its intelligent design, installation is completed quickly and with perfect alignment in just a few steps. The result is not only visually impressive but also reliably meets all technical requirements.

Essential features

- | Slim, elegant design and low maintenance
- | Uses TURBOFLEX mounting technology
- | Extension pin location holes
- | Built-in drainage
- | Can be used with Top Covers
- | For glass thicknesses 15-21.52mm
- | Easy installation with the Turbo Torque Tool
- | Align glass by hand
- | Screw fastening
- | Available in 2,5 and 5 m

Watch installation video:



Online manual:
Model TF-3621 without
height adjustment



Online manual:
Model TF-3621 with
height adjustment



TESTED
according to
BS6180

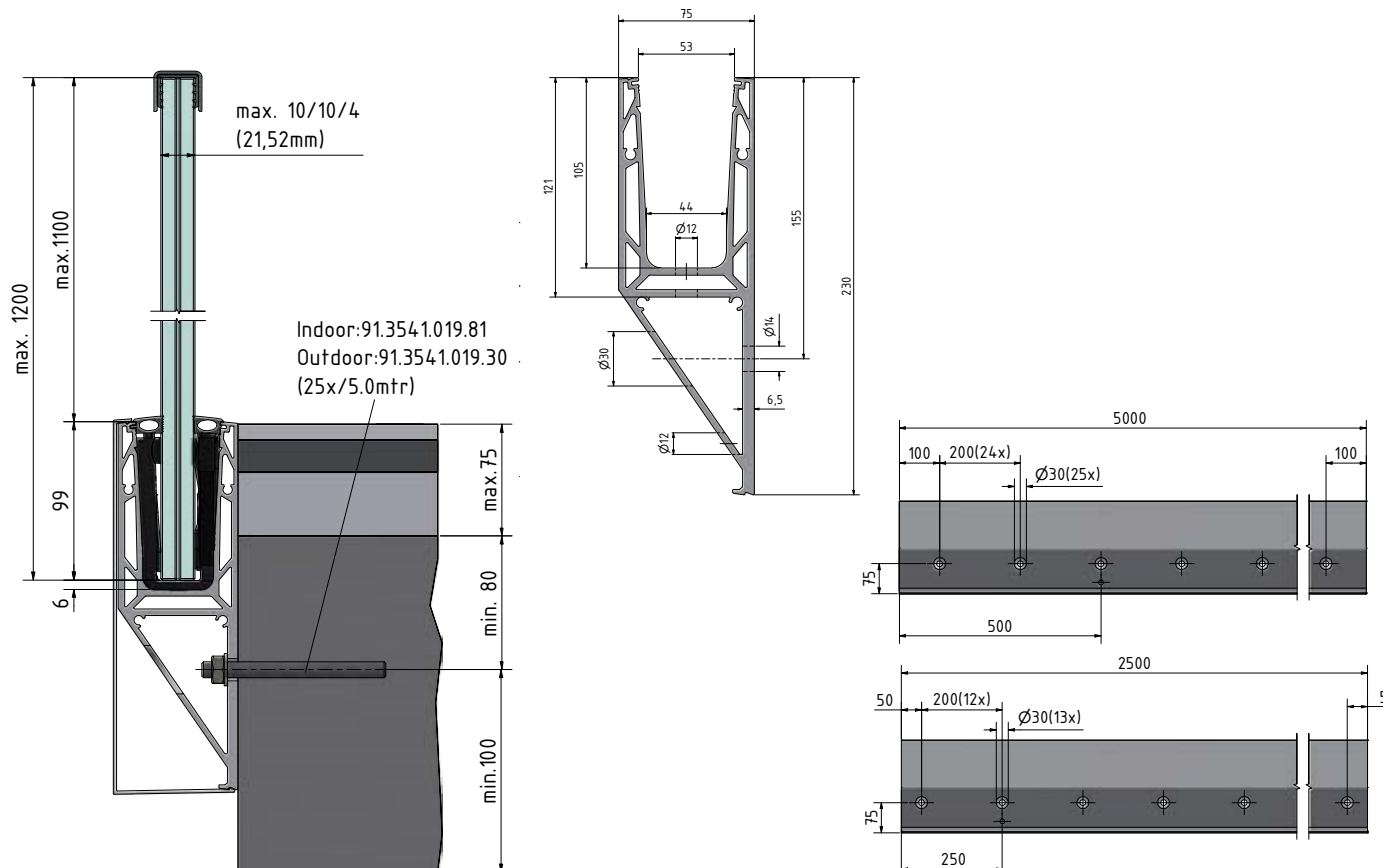



Side mount

equipped
with



TURBOFLEX
GLASS FIXATION ADJUSTS
TO THE GLASS POSITION



TF-3621 | 1.0 KN SIDE MOUNT

Glass profile



| Length: 2,5 and 5 m
| Sales unit: 1 piece

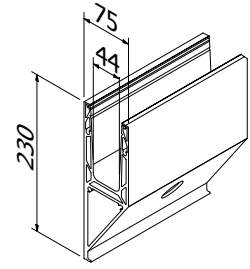

Model 3621	Mill finish	Plain aluminium	RAL coloured
Length	Art. No.	Art. No.	Art. No.
2,5 m	10.3621.002.10	10.3621.002.11	10.3621.002.13/16/18/19
5 m	10.3621.005.10	10.3621.005.11	10.3621.005.13/16/18/19

Inside corner 90°



| Inside length 125 mm
| Outside length 200 mm
| Sales unit: 1 piece

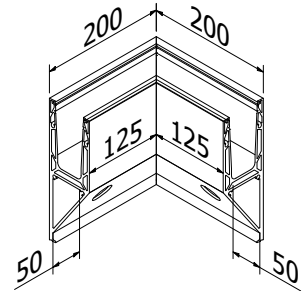

Model 3621	Mill finish	Plain aluminium	RAL coloured
	Art. No.	Art. No.	Art. No.
	10.3621.300.10	10.3621.300.11	10.3621.300.13/16/18/19

Outside corner 90°



| Inside length 125 mm
| Outside length 200 mm
| Sales unit: 1 piece

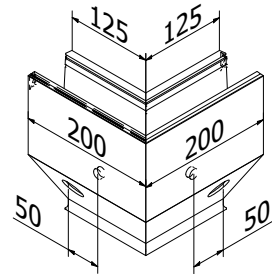

Model 3621	Mill finish	Plain aluminium	RAL coloured
	Art. No.	Art. No.	Art. No.
	10.3621.350.10	10.3621.350.11	10.3621.350.13/16/18/19

Cover cap



| With mounting strips
| Sales unit: 1 piece

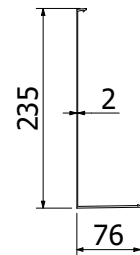

Model 3621	Mill finish	Plain aluminium	RAL coloured
Length	Art. No.	Art. No.	Art. No.
2,5 m	10.3621.202.10	10.3621.202.11	10.3621.202.13/16/18/19
5 m	10.3621.205.10	10.3621.205.11	10.3621.205.13/16/18/19

TF-3621 | 1.0 KN SIDE MOUNT

End cap, left, without cover cap



| For use on the left
| Sales unit: 1 piece

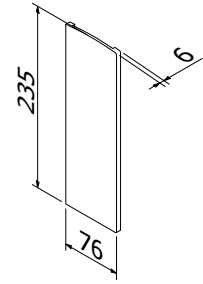

Model 3621	Mill finish	Plain aluminium	RAL coloured
Application	Art. No.	Art. No.	Art. No.
Left	10.3621.400.10	10.3621.400.11	10.3621.400.13/16/18/19

End cap, right, without cover cap



| For use on the right
| Sales unit: 1 piece

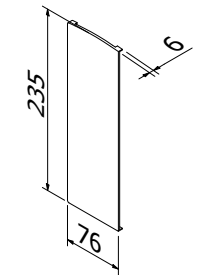

Model 3621	Mill finish	Plain aluminium	RAL coloured
Application	Art. No.	Art. No.	Art. No.
Right	10.3621.450.10	10.3621.450.11	10.3621.450.13/16/18/19

End cap, left, with cover cap



| For use on the left
| Sales unit: 1 piece

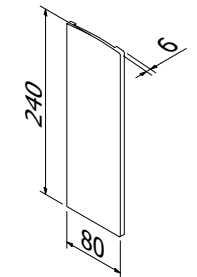

Model 3621	Mill finish	Plain aluminium	RAL coloured
Application	Art. No.	Art. No.	Art. No.
Left	10.3621.410.10	10.3621.410.11	10.3621.410.13/16/18/19

End cap, right, with cover cap



| For use on the right
| Sales unit: 1 piece

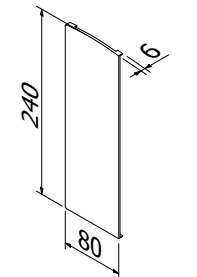

Model 3621	Mill finish	Plain aluminium	RAL coloured
Application	Art. No.	Art. No.	Art. No.
Right	10.3621.460.10	10.3621.460.11	10.3621.460.13/16/18/19

TF-3621 | 1.0 KN SIDE MOUNT

End cap for staircase, left, with cover cap



| For use on the left
| Cut-to-size
| Sales unit: 1 piece

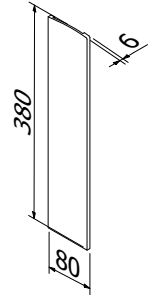

Model 3621	Mill finish	Plain aluminium	RAL coloured
Application	Art. No.	Art. No.	Art. No.
Left	10.3621.411.10	10.3621.411.11	10.3621.411.13/16/18/19

End cap for staircase, right, with cover cap



| For use on the right
| Cut-to-size
| Sales unit: 1 piece

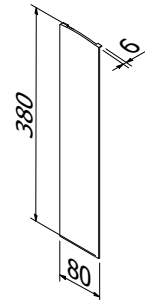

Model 3621	Mill finish	Plain aluminium	RAL coloured
Application	Art. No.	Art. No.	Art. No.
Right	10.3621.461.10	10.3621.461.11	10.3621.461.13/16/18/19

Spacer



| Thickness: 15 mm
| Sales unit: 13 pieces

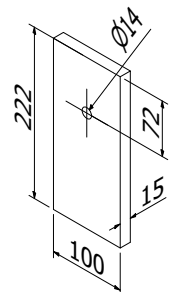

Model 3621	Mill finish	Plain aluminium	RAL coloured
	Art. No.	Art. No.	Art. No.
	10.3621.500.10	10.3621.500.11	10.3621.500.13/16/18/19

Extension pin



| Length 40 mm
| Diameter Ø 6 mm
| Sales unit: 8 pieces

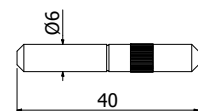

Model 7001	AISI 316
	Art. No.
	90.7001.640.31

TF-3621 | 1.0 KN SIDE MOUNT

Fischer fixing anchor RG M10x190



- | Finish interior application: zinc-plated steel (inside)
- | Finish exterior application: V4A (exterior)
- | Required number per 2500 mm: 7 pieces
- | M10
- | Suitable injection mortar: 91.3000.010.00 is sufficient for ± 22 anchors
- | Sales unit: 10 pieces

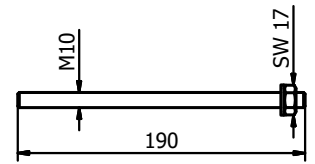

Model 3541	Zinc-plated steel (inside)	AISI 316 (exterior)
	Art. No.	Art. No.
	91.3541.019.81	91.3541.019.30

Mounting set for steel



- | Finish interior application: zinc-plated steel (inside)
- | Finish exterior application: V4A (exterior)
- | Required number per 2500 mm: 13 pieces
- | M12 x 50 mm
- | Sales unit: 13 pieces

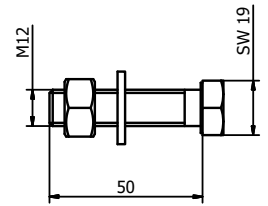

Model 3010	Zinc-plated steel (inside)	AISI 316 (exterior)
	Art. No.	Art. No.
	91.3010.050.81	91.3010.050.30

Mounting set for wood



- | Finish interior application: zinc-plated steel (inside)
- | Required number per 2500 mm: 13 pieces
- | RAMPA | M12x35
- | Sales unit: 13 pieces

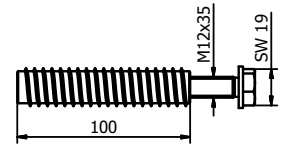

Model 3010	Zinc-plated steel (inside)
	Art. No.
	91.3010.800.81

TURBOFLEX GLASS PROFILE TF-6620

1.50 kN TOP MOUNT

New concept for installing frameless glass balustrades

Easily and precisely position the glass exactly where it matters - directly at the glass itself! The TURBOFLEX system allows for maximum adjustment accuracy and significantly reduces installation time.

TF-6620 has been specifically developed for top mounted installations and can be easily secured to concrete and steel substrates. Thanks to its intelligent design, installation is completed quickly and with perfect alignment in just a few steps. The result is not only visually impressive but also reliably meets all technical requirements.

Essential features

- | Slim, elegant design and low maintenance
- | Uses TURBOFLEX mounting technology
- | Extension pin location holes
- | Built-in drainage
- | Can be used with 3.0 kN Top Covers
- | For glass thicknesses 15-21.52mm
- | Easy installation with the Turbo Torque Tool
- | Align glass by hand
- | Screw fastening
- | Available in 2,5 and 5 m

Watch Installation Video:



Online manual: Model TF-6620 without height adjustment



Online manual: Model TF-6620 with height adjustment



TESTED
according to
BS6180

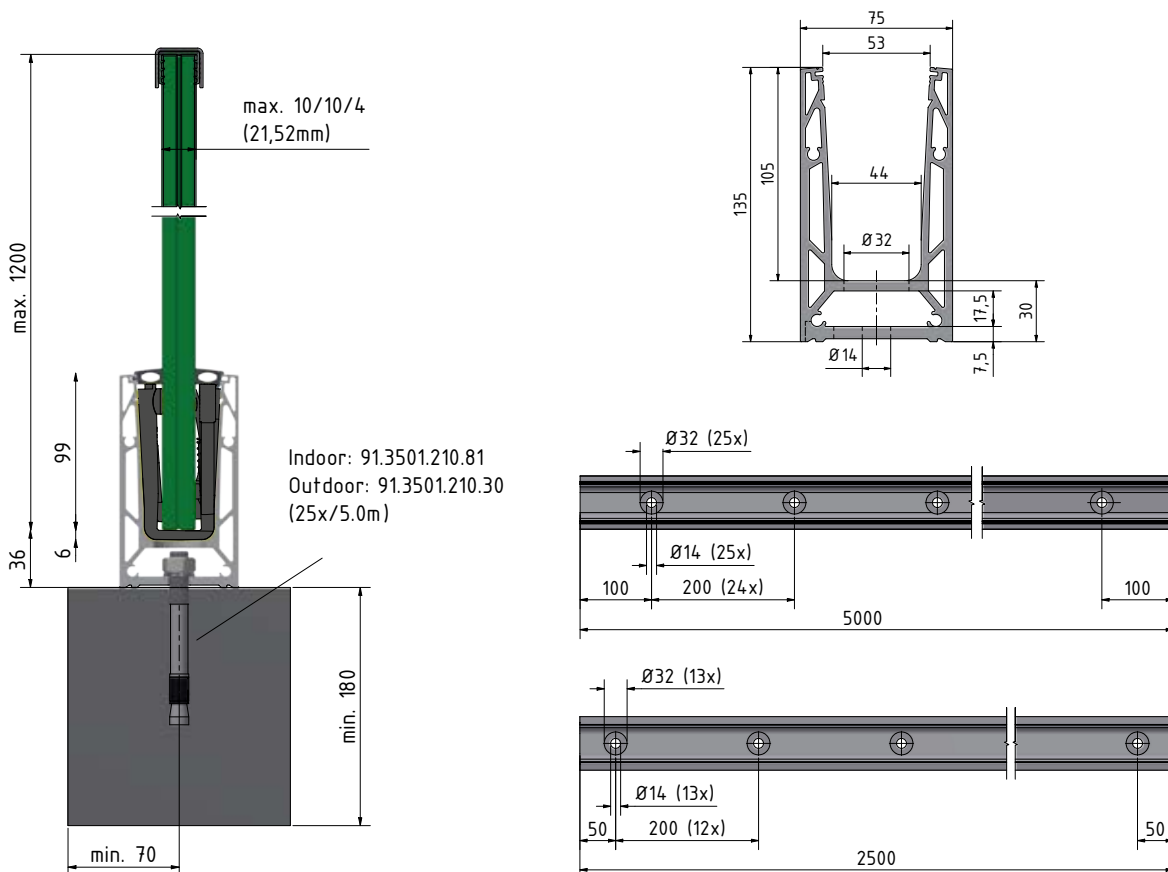

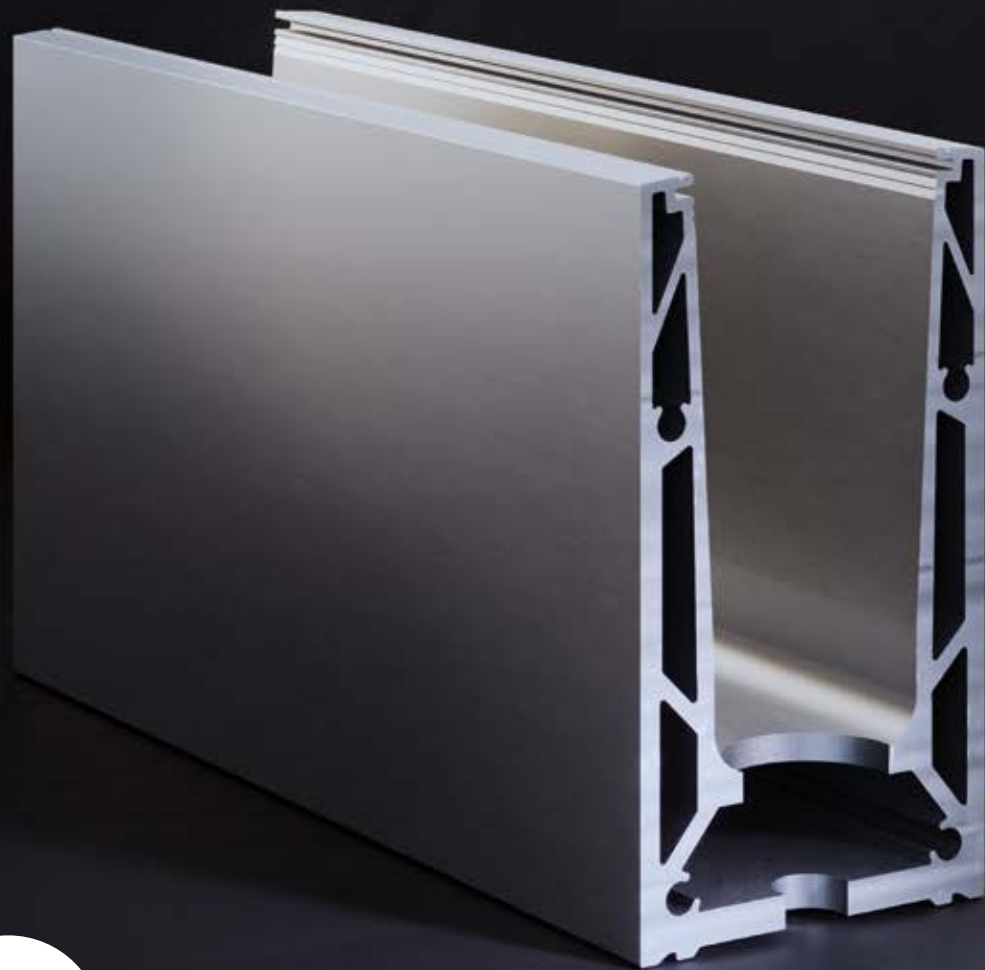

equipped
with



TURBOFLEX
GLASS FIXATION ADJUSTS
TO THE GLASS POSITION



Top mount



TF-6620 | 1.50 KN TOP MOUNT

Glass profile



| Length: 2,5 and 5 m
| Sales unit: 1 piece

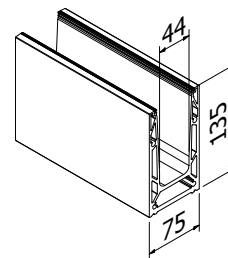

Model 6620	Mill finish	Plain aluminium	RAL coloured
Length	Art. No.	Art. No.	Art. No.
2,5 m	10.6620.002.10	10.6620.002.11	10.6620.002.13/16/18/19
5 m	10.6620.005.10	10.6620.005.11	10.6620.005.13/16/18/19

Inside corner / outside corner 90°



| Side length inside 125 mm
| Side length outside 200 mm
| Sales unit: 1 piece

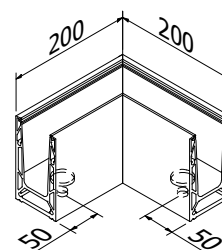

Model 6620	Mill finish	Plain aluminium	RAL coloured
	Art. No.	Art. No.	Art. No.
	10.6620.390.10	10.6620.390.11	10.6620.390.13/16/18/19

End cap, left/right



| For use on the left and right
| Sales unit: 1 piece

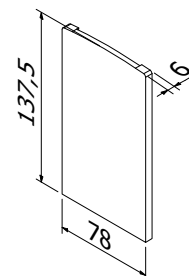

Model 6620	Mill finish	Plain aluminium	RAL coloured
Application	Art. No.	Art. No.	Art. No.
Left/right	10.6620.490.10	10.6620.490.11	10.6620.490.13/16/18/19

End cap for staircase, left/right



| For use on the left and right
| Can be cut to size
| Sales unit: 1 piece

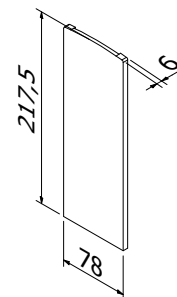

Model 6620	Mill finish	Plain aluminium	RAL coloured
Application	Art. No.	Art. No.	Art. No.
Left/right	10.6620.491.10	10.6620.491.11	10.6620.491.13/16/18/19

TAKE A LITTLE DISTANCE – WITH OUR SPACER.

Hoover Dam is a thing of the past. There is more water on balconies than in the legendary dammed Colorado River. We have the suitable spacer for every profile to keep your feet dry. In addition, our spacers are constructed such as to adapt themselves to all static conditions.

10.6620.500.xx

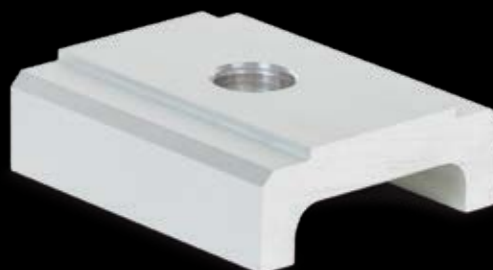

TF-6620 | 1.50 KN TOP MOUNT

Spacer



For additional drainage solutions on your balcony, simply mount the spacers beneath the profile

- | Outlet \varnothing 14 mm
- | Sales unit: 13 pieces

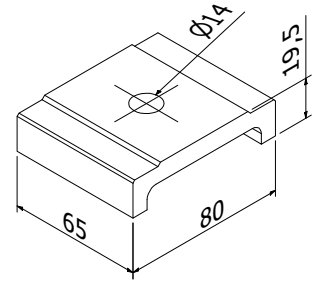

Model 6620	Mill finish	Plain aluminium	RAL coloured
	Art. No.	Art. No.	Art. No.
	10.6620.500.10	10.6620.500.11	10.6620.500.13/16/18/19

Extension pin



- | Length 40 mm
- | Diameter \varnothing 6 mm
- | Sales unit: 8 pieces

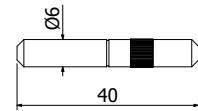

Model 7001	AISI 316 (inside & outside)
	Art. No.
	90.7001.640.31

Fischer fixing anchor FAZ II 12/10



- | Required number per 5000 mm: 25 pieces
- | Sales unit: 20 pieces

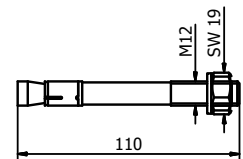

Model 3501	Zinc-plated steel (inside)	AISI 316 (exterior)
	Art. No.	Art. No.
	91.3501.210.81	91.3501.210.30

Mounting set for steel



- | Required number per 5000 mm: 25 pieces
- | M12 x 50 mm
- | Sales unit: 13 pieces

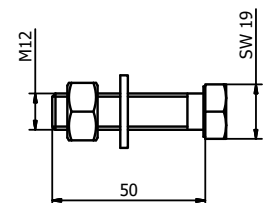

Model 6620	Zinc-plated steel (inside)	AISI 316 (exterior)
	Art. No.	Art. No.
	91.6620.050.81	91.6620.050.30



TURBOFLEX GLASS PROFILE TF-6621

0.74 kN SIDE MOUNT

New concept for installing frameless glass balustrades

Easily and precisely position the glass exactly where it matters - directly at the glass itself! The TURBOFLEX system allows for maximum adjustment accuracy and significantly reduces installation time.

TF-6621 has been specifically developed for side mounted installations and can be easily secured to concrete and steel substrates. Thanks to its intelligent design, installation is completed quickly and with perfect alignment in just a few steps. The result is not only visually impressive but also reliably meets all technical requirements.

Essential features

- | Slim, elegant design and low maintenance
- | Uses TURBOFLEX mounting technology
- | Extension pin location holes
- | Built-in drainage
- | Can be used with Top Covers
- | For glass thicknesses 15-21.52mm
- | Easy installation with the Turbo Torque Tool
- | Align glass by hand
- | Screw fastening

Watch installation video:



Online manual:
Model TF-6621 without
height adjustment



Online manual:
Model TF-6621 with
height adjustment



TESTED
according to
BS6180

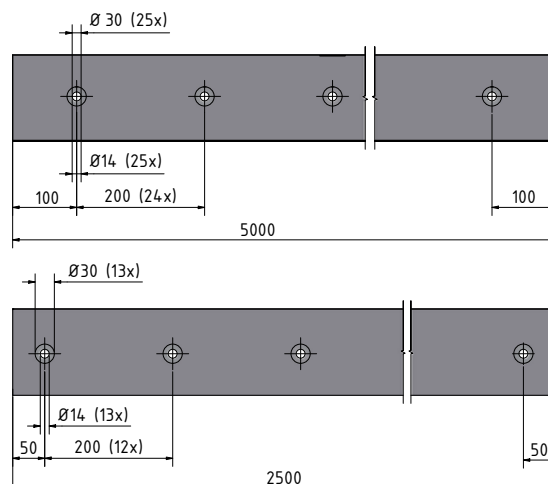
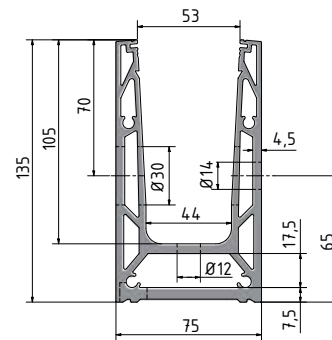
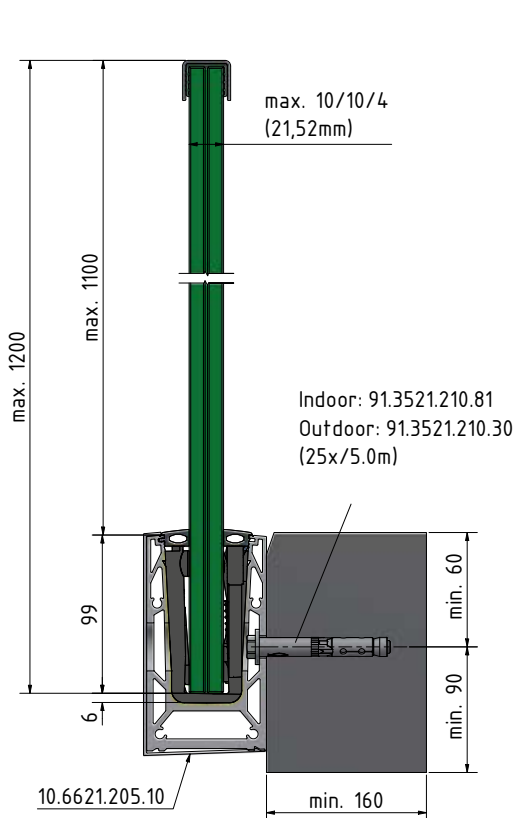

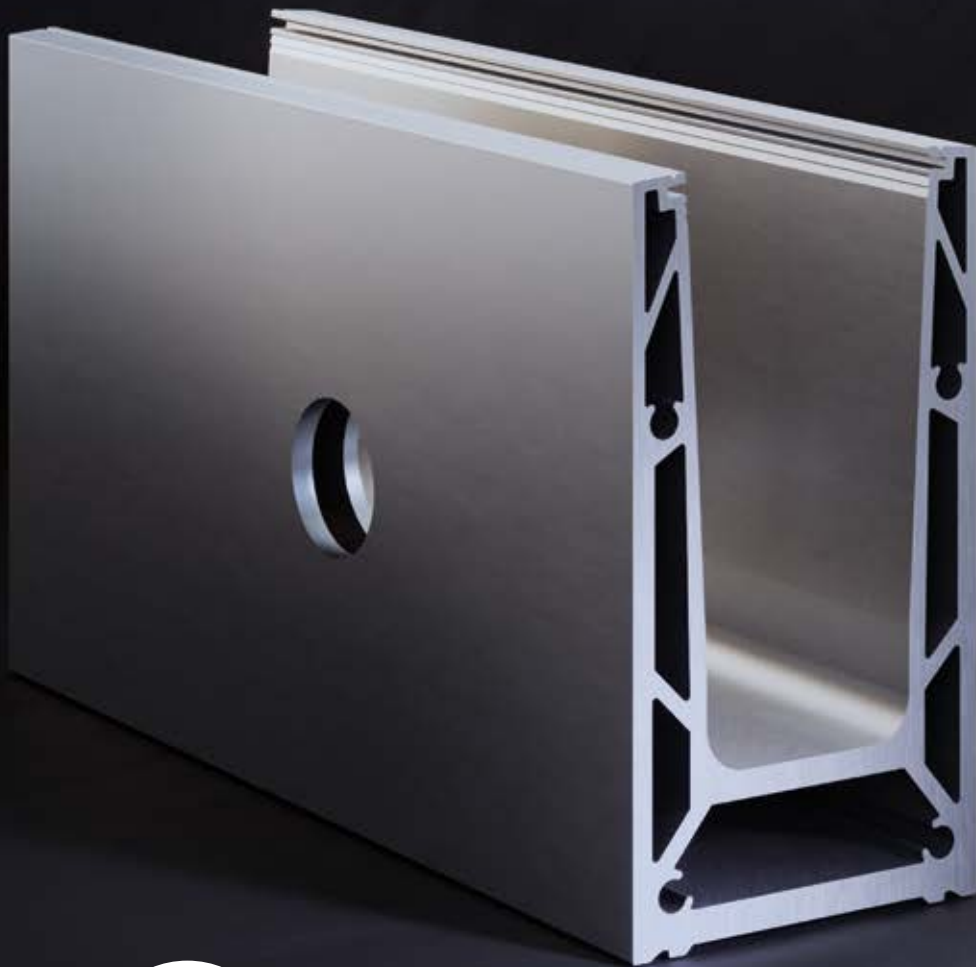

Side mount

equipped
with



TURBOFLEX
GLASS FIXATION ADJUSTS
TO THE GLASS POSITION



TF-6621 | 0.74 KN SIDE MOUNT

Glass profile



| Length: 2,5 and 5 m
| Sales unit: 1 piece

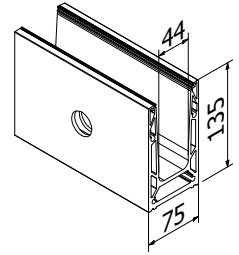

Model 6621	Mill finish	Plain aluminium	RAL coloured
Length	Art. No.	Art. No.	Art. No.
2,5 m	10.6621.002.10	10.6621.002.11	10.6621.002.13/16/18/19
5 m	10.6621.005.10	10.6621.005.11	10.6621.005.13/16/18/19

Inside corner 90°



| Inside length 125 mm
| Outside length 200 mm
| Sales unit: 1 piece

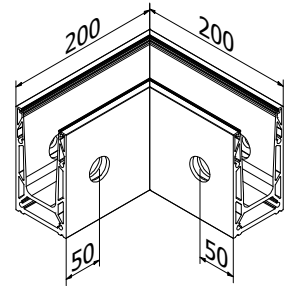

Model 6621	Mill finish	Plain aluminium	RAL coloured
	Art. No.	Art. No.	Art. No.
	10.6621.300.10	10.6621.300.11	10.6621.300.13/16/18/19

Outside corner 90°



| Inside length 125 mm
| Outside length 200 mm
| Sales unit: 1 piece

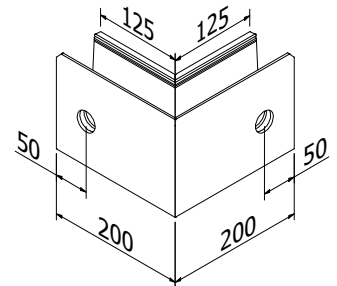

Model 6621	Mill finish	Plain aluminium	RAL coloured
	Art. No.	Art. No.	Art. No.
	10.6621.350.10	10.6621.350.11	10.6621.350.13/16/18/19

Cover cap



| With mounting strips
| Sales unit: 1 piece

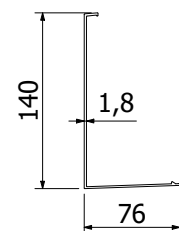

Model 6621	Mill finish	Plain aluminium	RAL coloured
Length	Art. No.	Art. No.	Art. No.
5 m	10.6621.205.10	10.6621.205.11	10.6621.205.13/16/18/19

TF-6621 | 0.74 KN SIDE MOUNT

End cap, left, without cover cap



| For use on the left
| Sales unit: 1 piece

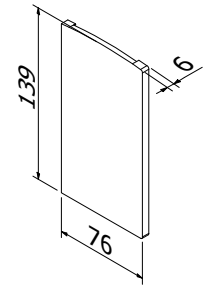

Model 6621	Mill finish	Plain aluminium	RAL coloured
Application	Art. No.	Art. No.	Art. No.
Left	10.6621.400.10	10.6621.400.11	10.6621.400.13/16/18/19

End cap, right, without cover cap



| For use on the right
| Sales unit: 1 piece

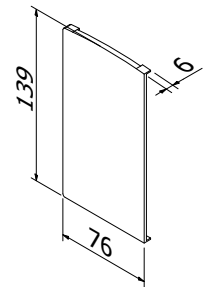

Model 6621	Mill finish	Plain aluminium	RAL coloured
Application	Art. No.	Art. No.	Art. No.
Right	10.6621.450.10	10.6621.450.11	10.6621.450.13/16/18/19

End cap, left, with cover cap



| For use on the left
| Sales unit: 1 piece

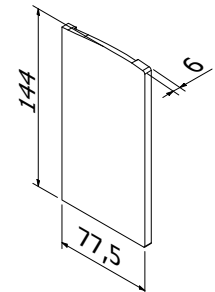

Model 6621	Mill finish	Plain aluminium	RAL coloured
Application	Art. No.	Art. No.	Art. No.
Left	10.6621.410.10	10.6621.410.11	10.6621.410.13/16/18/19

End cap, right, with cover cap



| For use on the right
| Sales unit: 1 piece

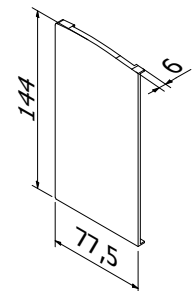

Model 6621	Mill finish	Plain aluminium	RAL coloured
Application	Art. No.	Art. No.	Art. No.
Right	10.6621.460.10	10.6621.460.11	10.6621.460.13/16/18/19

TF-6621 | 0.74 KN SIDE MOUNT

End cap for staircase, left, with cover cap



| For use on the left
| Cut-to-size
| Sales unit: 1 piece

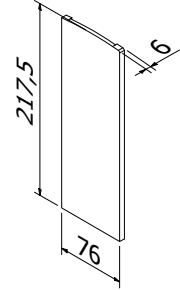

Model 6621	Mill finish	Plain aluminium	RAL coloured
Application	Art. No.	Art. No.	Art. No.
Left	10.6621.411.10	10.6621.411.11	10.6621.411.13/16/18/19

End cap for staircase, right, with cover cap



| For use on the right
| Cut-to-size
| Sales unit: 1 piece

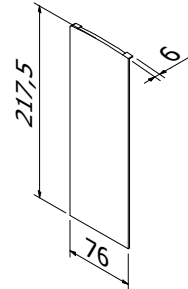

Model 6621	Mill finish	Plain aluminium	RAL coloured
Application	Art. No.	Art. No.	Art. No.
Right	10.6621.461.10	10.6621.461.11	10.6621.461.13/16/18/19

Spacer



| Thickness: 15 mm
| Sales unit: 13 pieces

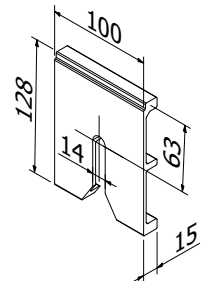

Model 6621	Mill finish	Plain aluminium	RAL coloured
	Art. No.	Art. No.	Art. No.
	10.6621.500.10	10.6621.500.11	10.6621.500.13/16/18/19

Extension pin



| Length 40 mm
| Diameter Ø 6 mm
| Sales unit: 8 pieces

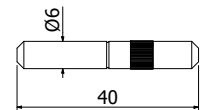

Model 7001	AISI 316
	Art. No.
	90.7001.640.31

TF-6621 | 0.74 KN SIDE MOUNT

Fischer fixing anchor FH II 12/10



| Required number per 5000 mm: 25 pieces
| Sales unit: 25 pieces

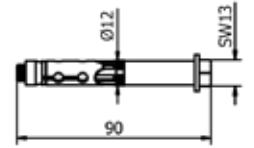

Model 3521	Zinc-plated steel (inside)	AISI 316 (exterior)
Art. No.	Art. No.	Art. No.
	91.3521.210.81	91.3521.210.30

Mounting set for steel



| Required number per 5000 mm: 25 pieces
| M12 x 50 mm
| Sales unit: 13 pieces

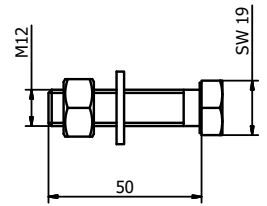

Model 6621	Zinc-plated steel (inside)	AISI 316 (exterior)
Art. No.	Art. No.	Art. No.
	91.6621.050.81	91.6621.050.30

ONLEVEL

ONLEVEL Ltd. | Unit 7, Alexandria Court | Alexandria Drive
Ashton Commerce Park | Ashton-under-Lyne | Lancashire OL7 0QN | United Kingdom
T +44 0161 804 9500 | info@onlevel-uk.com | www.onlevel-uk.com